

# 3900 Series 40' Rib Side Boxcar

## ASSEMBLY INSTRUCTIONS

- 1 Cut parts from sprues using a sharp hobby knife. Trim all sprue material from underside of Roof (*must be flush for roof to fit properly*). Trim flush all tabs on underside of running board.
- 2 Cement Running Board to roof, making sure it's centered, with both ends overhanging an equal amount (approx 1/8"). Set aside to dry.
- 3 Cement Brake Reservoir into place with the double mounting tabs pointing toward the brake wheel end of the car.
- 4 Install Triple Valve with its mounting pin and then cement the Brake Cylinder/Lever in place with the brake lever parallel to the floor.
- 5 Wipe the Steel Weight clean to help adhesion, then affix inside of car body with cement or double-sided tape.
- 6 Cement Roof in place, using sparing amounts of glue on the top, inside edge of the body shell to keep it from seeping out. Let dry.
- 7 Install Brake Platform, detail side up. Then with tweezers, cement Brake Platform Supports in place.
- 8 Cement Running Board Supports in place, ensuring that they are perfectly vertical.
- 9 Cement End Ladders (shorter ones) in place. Then the Side Ladders.
- 10 Cement Brake Wheel in place.
- 11 Insert Brake Rod through hole in Brake Platform. Cement fulcrum into slot next to coupler box and affix brake rod with a small dot of cement on the underside of the brake platform.
- 12 Insert Couplers in Coupler Box. Install with Coupler Cover and self-tapping Screws. The tab on the Coupler Cover should be on the interior of the Coupler Box, oriented toward the knuckles.
- 13 Install wheels into the trucks, then install the trucks onto the floor with screws. Do not overtighten.
- 14 Glue Tack Boards to Doors, centered on closest-together pair of ribs. Glue Tack Boards to car ends at the same height.

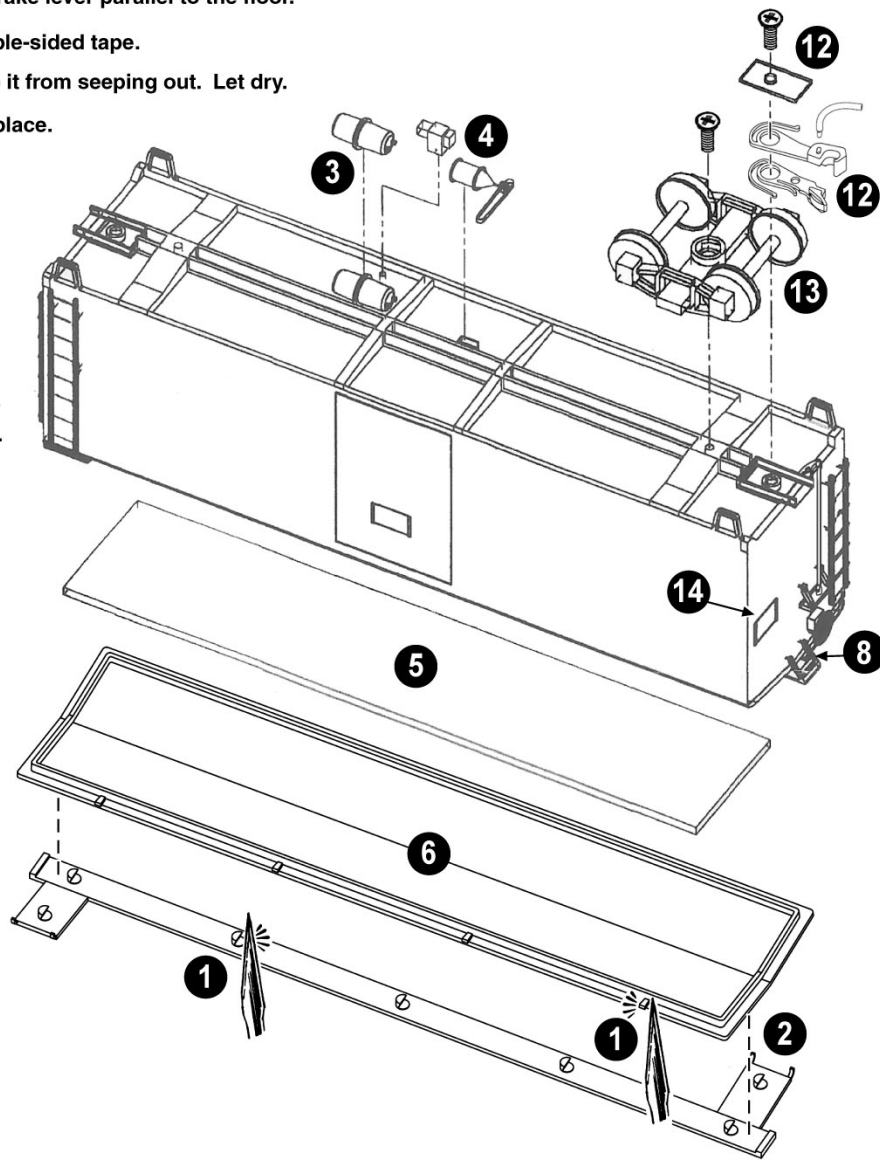
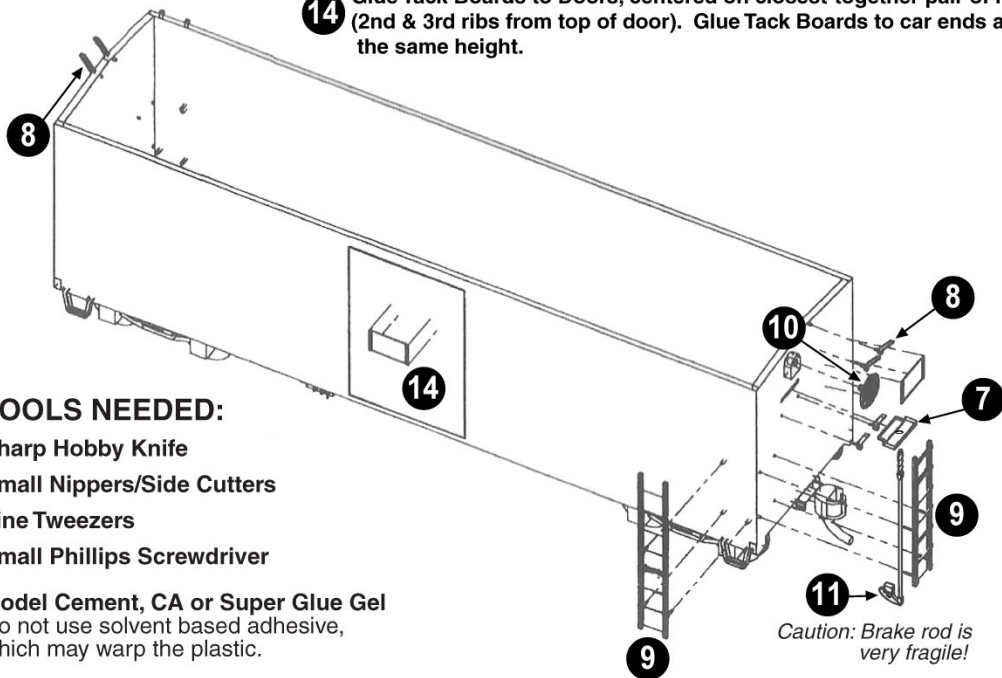

### TOOLS NEEDED:

- Sharp Hobby Knife
- Small Nippers/Side Cutters
- Fine Tweezers
- Small Phillips Screwdriver

Model Cement, CA or Super Glue Gel  
 Do not use solvent based adhesive,  
 which may warp the plastic.

Caution: Brake rod is  
 very fragile!